



City of Cleveland Land Bank

Application to Purchase Property for Yard Expansions

Through the sale of Land Bank parcels for the expansion of residential yards, the City of Cleveland offers its citizens a way to participate in the revitalization of the City and also benefit themselves through the productive reuse of vacant lots. This application is for individuals or companies that wish to purchase land owned by the City of Cleveland for the purpose of yard expansions for residential properties. Please confirm with the City's online Land Bank Database on the web (http://cd.city.cleveland.oh.us/scripts/cityport.php) that the property you wish to purchase is in the City's ownership or call (216)664-4126. NOTE: If you plan to construct a garage as part of the yard expansion, do not use this form, but use the Application to Purchase Property for Development.

Eligibility:

- 1. An applicant must not have any outstanding housing code violations or property tax delinquencies.
2. An applicant must be the owner of a property adjacent to the land bank parcel that is being requested for purchase.
3. An applicant must submit a full and complete application with the required attachments to the City of Cleveland's Community Development Department Division of Real Estate for it to be accepted for processing and review.

Applicant Information:

Applicant's Name _____ Date _____
Mailing Address _____
Email Address _____
Telephone Number _____ Alt. Telephone Number _____

Address of residential property adjacent to Land Bank parcel(s) _____
Parcel Number(s) of residential property adjacent to Land Bank parcel(s) _____
How long has the applicant owned the above residential property? _____

Is the residential property owner occupied (Do you live in the property)? Yes [] No []
Is the residential property rental property? Yes [] No []
Do you own other property within the City of Cleveland? Yes [] No []

If "Yes", please list the addresses and types of property (please add a separate sheet of paper if you need more space)

Addresses for Buildings (Parcel Numbers for Vacant Lots) Type of Property

Land Bank Parcel Information:

Address and parcel number(s) of the Land Bank parcels you wish to purchase for yard expansion:

Are you currently using the land bank parcel? Yes No

If "Yes", have you made any improvements to the Land Bank parcel? Yes No

If "Yes", what improvements have been made? _____

Yard Expansion Improvement Information:

To promote the expansion of residential yards on vacant lots, the City is willing to sell parcels to adjacent residential property owners at a discounted sales price:

- Parcels less than 40 feet in width at the street frontage or less than 4,800 square feet in area: \$1
- Parcels greater than 4,800 square feet in area: \$10 per linear foot of street frontage

In exchange for the discounted sales price, the City is interested in encouraging improvements such as landscaping (shrubs, trees, groundcover, etc.) and fencing. In making the decision to sell a Land Bank parcel for a yard expansion, the City will consider the extent of improvements the applicant proposes to make to the land bank parcel as part of their expanded yard and the impact those improvements will have on improving the overall value of the property and the neighborhood.

Please describe your plans for improving the Land Bank parcel (landscaping, gardens, pavement treatment, fences, etc.) _____

****Attach a simple site plan showing the improvements you propose to make.**

Please see the attached example of an acceptable site plan which includes the following:

- 1. Address of residential property, name of applicant, date of drawing;*
- 2. Lot outline of parcels, location of sidewalk and street, labeled with name and address number;*
- 3. Location of your existing house, driveway, fence, and garage, as applicable;*
- 4. Drawing of proposed improvements (plantings, fencing, pavement, grass, etc.) with descriptive labels;*
- 5. Show direction by adding a "north arrow"*

Applicant's Signature

Date

Applicant's Signature

Date

Applications Should Be Returned To:

Department of Community Development, Division of Real Estate - Land Bank Section
601 Lakeside Avenue, Room 325, Cleveland, OH 44114-1070

Questions? Call (216)664-4126 or (216)664-4130 (or email asarto2@city.cleveland.oh.us)



City of Cleveland Land Bank

Application to Purchase Property for Yard Expansions

Site Plan Attachment

(Return with Your Completed Application Form)

Name: _____ **Site Address:** _____

Phone Number: _____ **Date of Application** _____

Draw Your Plan in the Box Below or Attach a Separate Sheet.
(See the 2nd page for instructions on drawing your plan)

Indicate What Your Plans are for the Land Bank Lot – Drawing Your Plan

- Fill in your contact information
- Show the location of your existing house, driveway and garage in relation to the land bank lot and to the street and sidewalk. Label the street name and your house number.
- If you plan to build a fence show its proposed location and indicate the style, the type of material and how tall it will be.
- Identify the location of existing vegetation on the land bank lot such as trees and bushes and show the proposed location and label any new trees, bushes or gardens you plan to plant. Indicate if you will be planting new grass.
- Show any other improvements you plan to make such as patios, walkways, arbors, playsets, etc.
- Indicate on the drawing which direction is North

Example of an Acceptable Site Plan Attachment

Name: John and Jane Doe Site Address: 12345 Cleveland Street
Phone Number: 216 555-555 Date of Application: 1/1/10

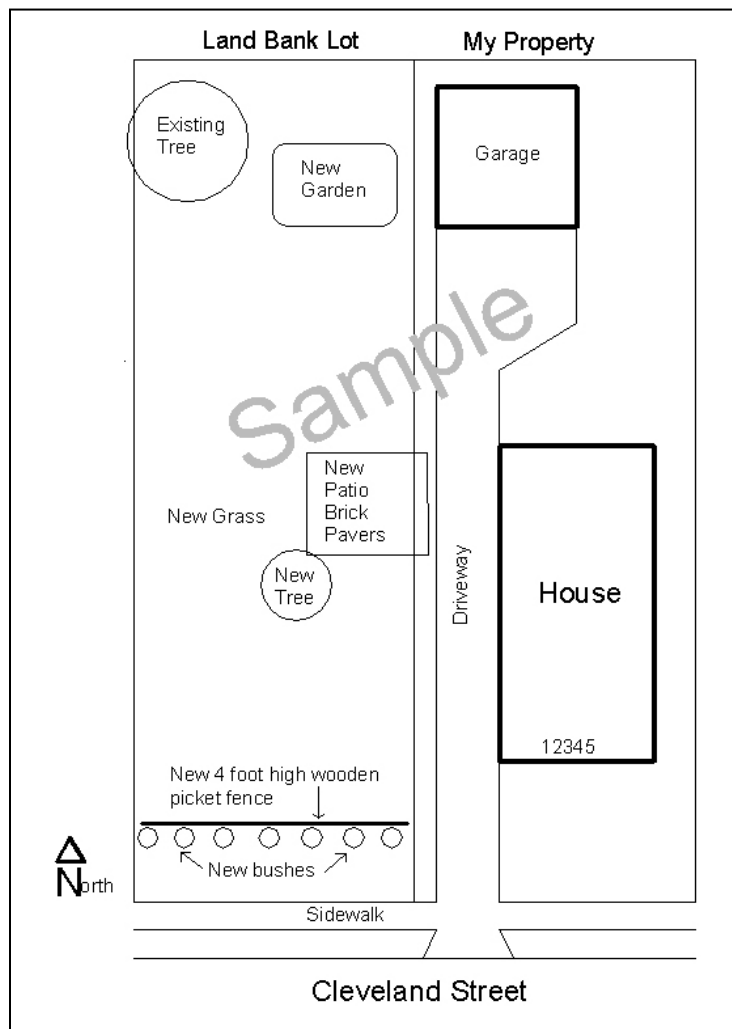

Site Plan Should Be Returned at the Same Time with the Application Form To:
Department of Community Development
Division of Real Estate - Land Bank Section
601 Lakeside Avenue, Cleveland, OH 44114-1070

Questions? Call (216) 664-4126 or e-mail asarto2@city.cleveland.oh.us

